





48/20 Eve Street Erskineville NSW

2  2  1 

Presenting the ideal lifestyle in one of Erskineville's most desirable developments, this property offers a light-filled sanctuary designed for comfort & style. The expansive East facing courtyard provides an ideal space for outdoor relaxation or entertaining, seamlessly blending in/outdoor living. Featuring two spacious bedrooms, the home has been tastefully updated w/ modern, high-quality finishes throughout, its thoughtful internal aspect maximizes natural light & privacy, creating a serene ambiance. Set in a resort-style living environment, the property offers accessible access from the street and/or secure car space to the apartment & luxury amenities that elevate comfort & convenience. With its harmonious blend of sophistication and relaxation - this home presents an ideal sanctuary for those seeking a stylish, tranquil retreat.

Type : Apartment
Price : Auction
Building Size : 132 sqm
Land Size : 132 sqm
View : <https://www.parkproperties.com.au/sale/nsw/inner-west/erskineville/residential/apartment/8267836>



Melissah McCaffery J P
02 9565 5333



Michael McCaffery
02 9565 5333

[For full version visit the website](https://www.parkproperties.com.au)

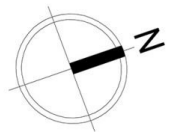
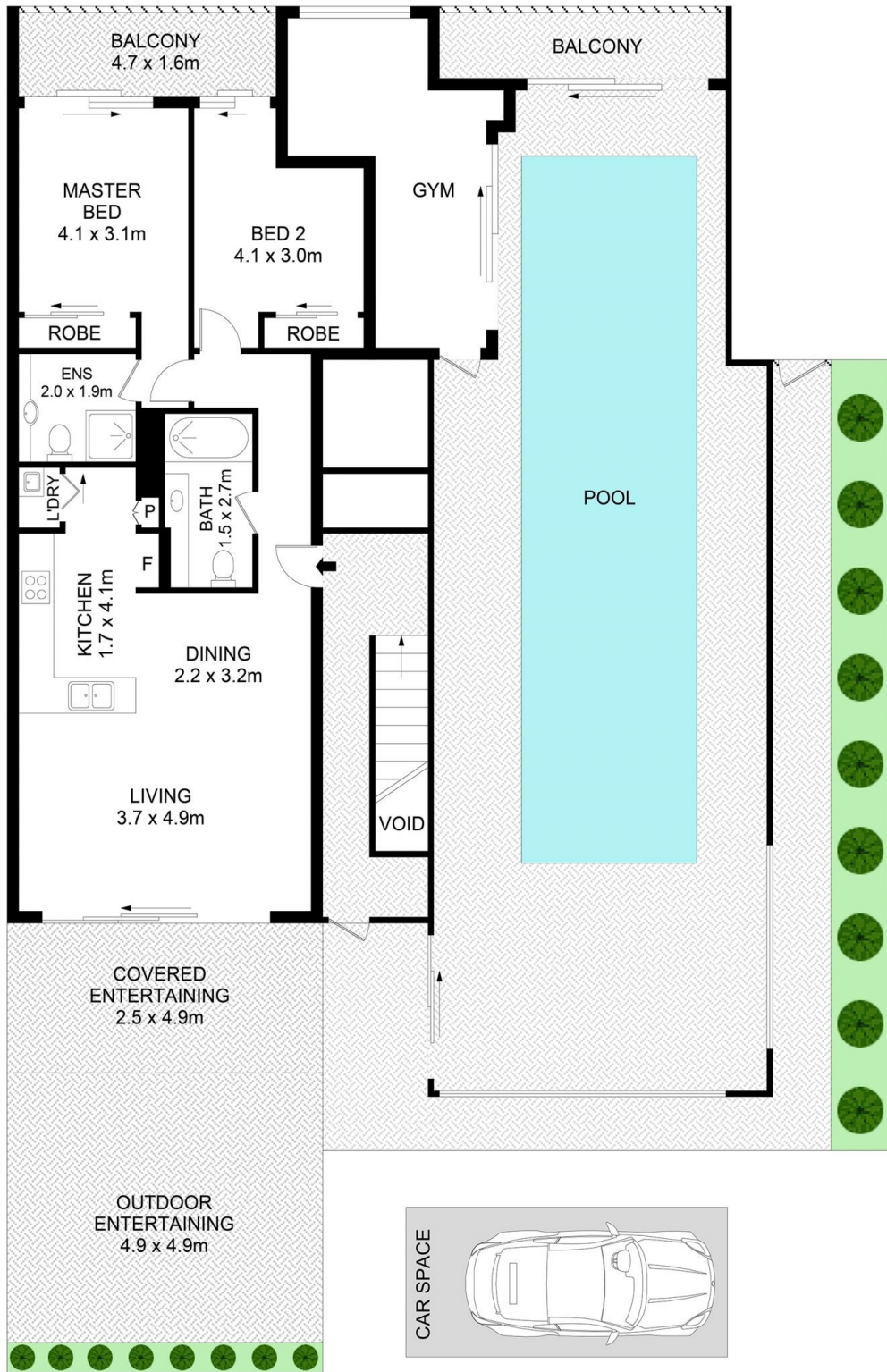

48/20 Eve Street, Erskineville



Disclaimer

Floor Plan measurements are approximate and are for illustrative purposes only. While we cannot doubt the floor plans accuracy, we make no guarantee, warranty or representation as to the accuracy and completeness of the floor plan.