



11305/177-219 Mitchell Road Erskineville NSW

1  1  1 

Situated in the sought-after landmark 'Sydney Park Village', this one bedroom apartment featuring a private aspect w/ desirable park views offers oversized living spaces + a designated study. Step into a convenient urban position in a sought-after location, so close to Erko village life & the CBD. Enjoying an in/out-door flow that allows for relaxation or entertaining - this is low maintenance inner west living at its optimum.

Price : \$ 720,000
Land Size : 79 sqm
View : <https://www.parkproperties.com.au/sale/nsw/inner-west/erskineville/residential/apartmen/t/7369765>

Double brick & quality building
 Generous open plan living and dining area
 Private entertainer's balcony w/ views to Sydney Park
 Quality gas kitchen w/ s/steel appliances & plenty of storage
 Generous bedroom w/ built in robe & private outlook
 Study perfect for home office or 2nd bedroom
 Stylish bathroom w/ bath & laundry facilities



Melissah McCaffery J P
02 9565 5333



Michael McCaffery
02 9565 5333

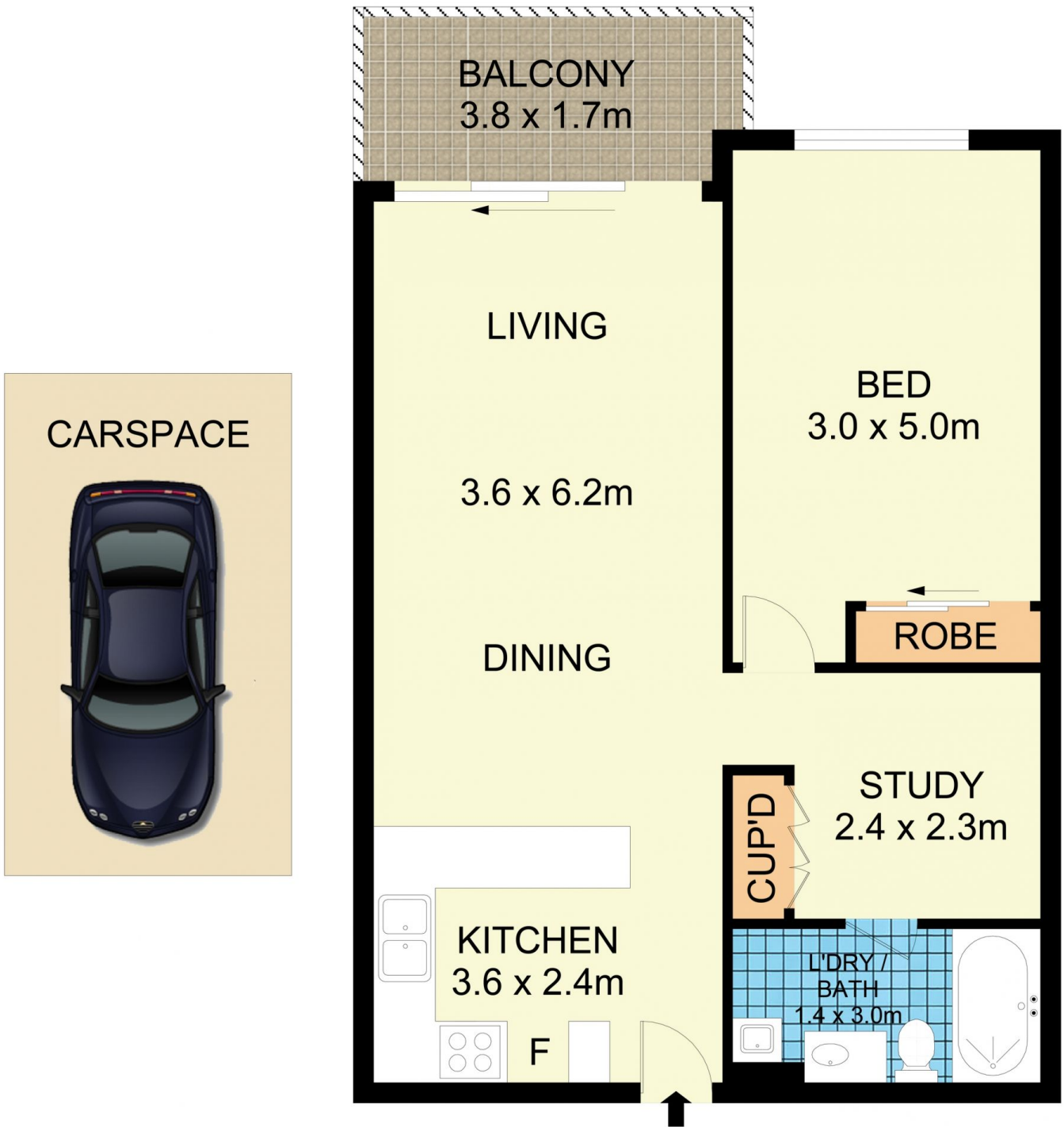

11305/177-219 Mitchell Road, Erskineville

Disclaimer

Floor Plan measurements are approximate and are for illustrative purposes only. While we cannot doubt the floor plans accuracy, we make no guarantee, warranty or representation as to the accuracy and completeness of the floor plan.