



18501/177-219 Mitchell Road Erskineville NSW

2  2  1 

Set within the lush-green surrounds of Sydney Park Village, this desirable two bedroom apartment with secure basement parking has a generous 110 sqm on title. Featuring an open plan layout with light filled interiors throughout, premium garden views and convenient location inspires a promising yet effortless inner city lifestyle.

Double brick & quality building
Open plan living & dining area w/ air-conditioning
Covered outdoor area w/ desirable internal views of the complex gardens + outdoor pool
Well-appointed gas kitchen w/ quality appliances & plenty of storage
Master bedroom w/ WIR & ensuite
Generous second bedroom w/ BIR
Stylish main bathroom w/ tub & separate laundry
Security intercom, direct access to secure basement

Price : \$ 998,000
Building Size : 110 sqm
View : <https://www.parkproperties.com.au/sale/nsw/inner-west/erskineville/residential/apartment/7152031>



Michael McCaffery
02 9565 5333



Rebecca Voncina
02 9565 5333

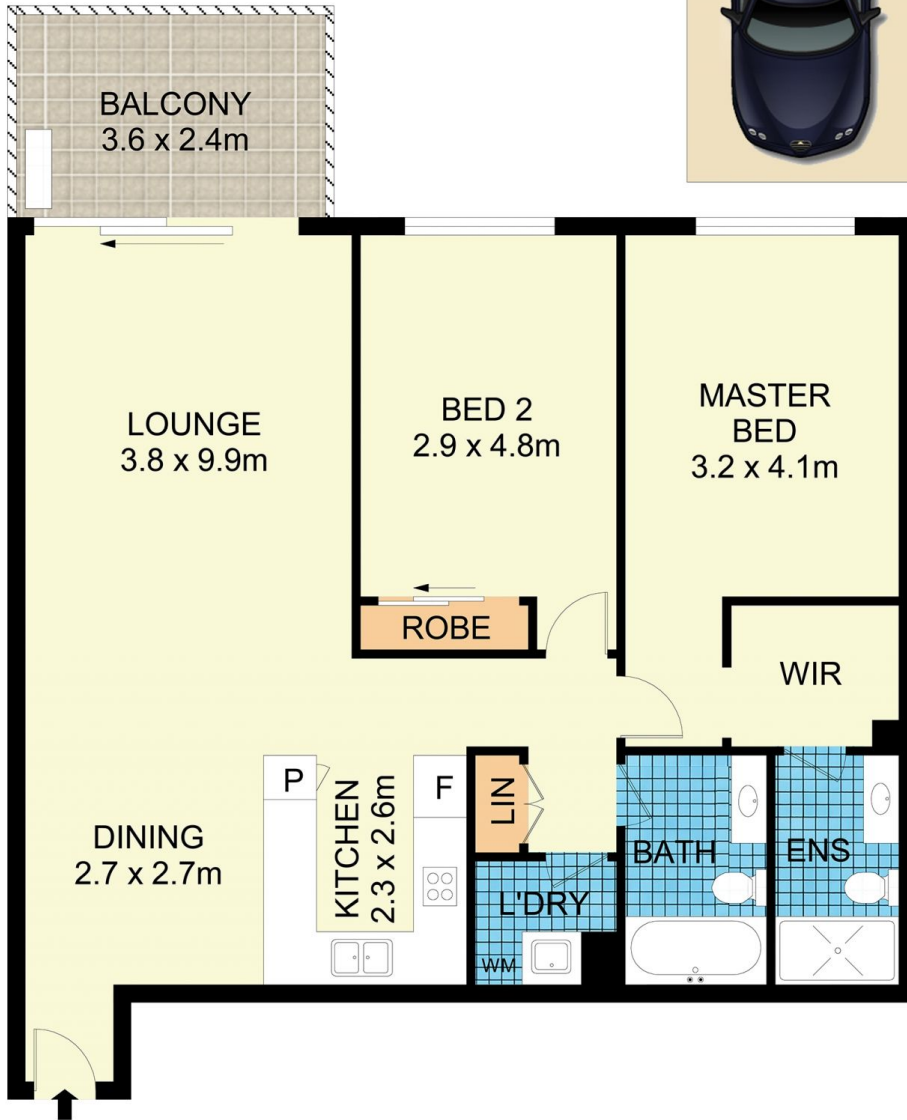
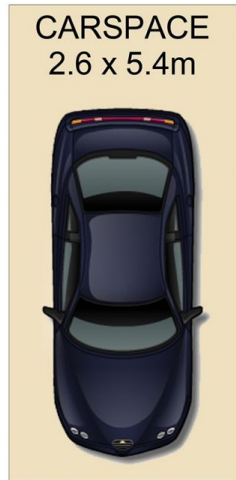
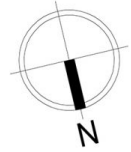

18501/177-219 Mitchell Road, Erskineville

Disclaimer

Floor Plan measurements are approximate and are for illustrative purposes only. While we cannot doubt the floor plans accuracy, we make no guarantee, warranty or representation as to the accuracy and completeness of the floor plan