



13604/177-219 Mitchell Road Erskineville NSW

2  **2**  **1** 

Set within the exclusive Sydney Park Village complex, this two bedroom apartment is located on the top floor, featuring a desirable open plan layout w/ blissful park views from the balcony. Complete with lift access to secure parking and conveniently located only footsteps away to shops, public transport, vibrant village bars and eateries.

Open plan living & dining area w/ air conditioning
Well appointed gas kitchen w/ s/s appliances
Covered balcony w/ panoramic park views
Master bedroom w/ WIR, ensuite & balcony access
Generous second bedroom w/ BIR
Main bathroom w/ bathtub & separate laundry
Secure undercover parking & ample visitor parking
Security intercom, lift access & 24/7 on-site security
Strata by laws changing to formally allow pets
Strata levies approx. \$1,500/q

Price : \$ 888,000

View : <https://www.parkproperties.com.au/sale/nsw/inne-r-west/erskineville/residential/apartment/6499658>



Michael McCaffery
02 9565 5333



Rebecca Voncina
02 9565 5333

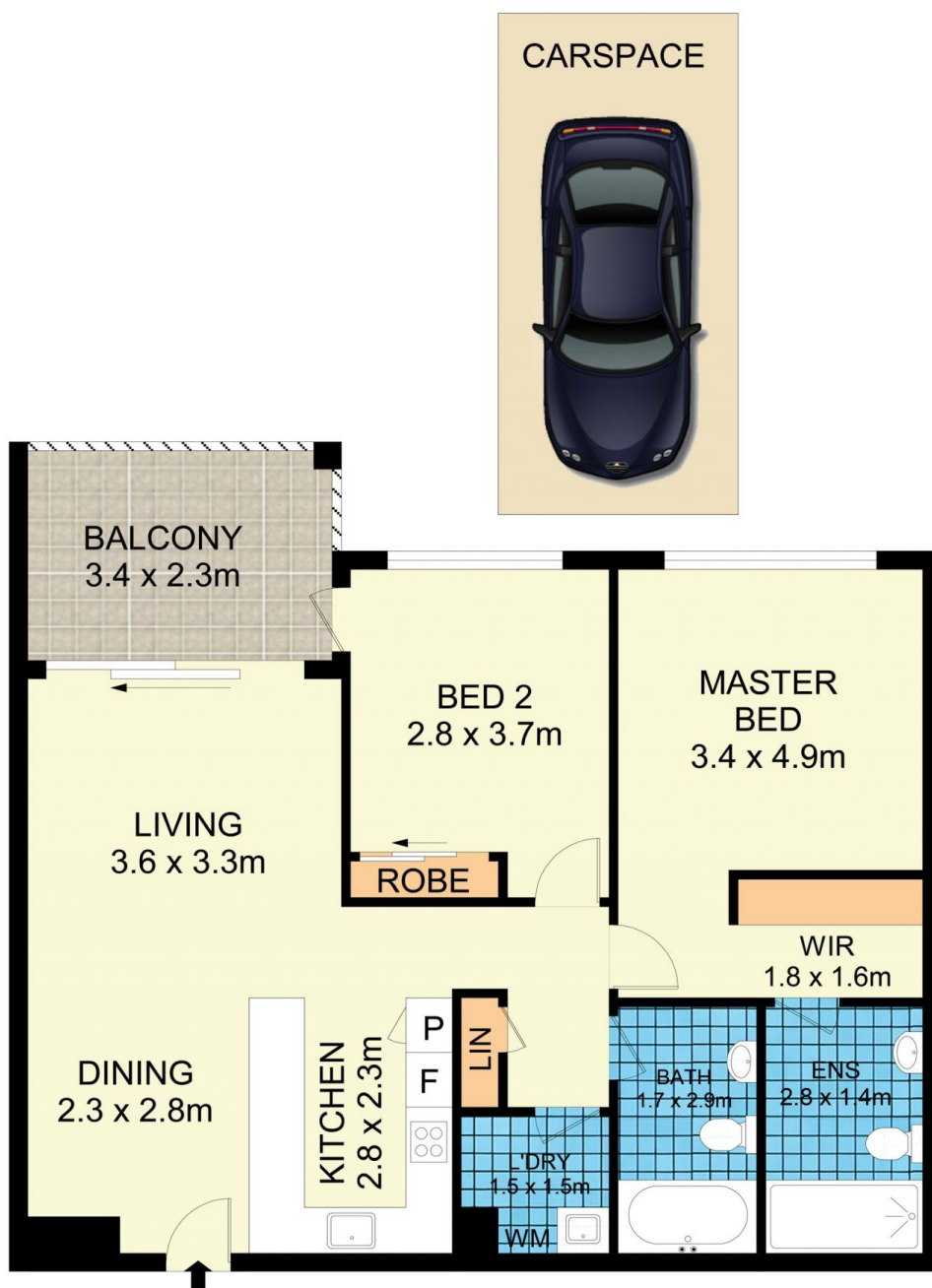

13604/177-219 Mitchell Road, Erskineville

Disclaimer

Floor Plan measurements are approximate and are for illustrative purposes only. While we cannot doubt the floor plans accuracy, we make no guarantee, warranty or representation as to the accuracy and completeness of the floor plan