



6301/177-219 Mitchell Road Erskineville NSW

1  1  1 

Nestled amid the oasis-like gardens of Sydney Park Village, this one bedroom apartment features an open plan layout with light filled interiors and recently renovated throughout - with nothing to spend, perfectly suited for first home buyers or investors alike.

Open plan living & dining area
Covered private balcony w/ leafy outlook
New gas kitchen w/ s/s appliances & storage
Main bedroom w/ mirrored BIR
New bathroom & separate laundry
Secure undercover parking & ample visitor parking
Intercom access & 24 hour on-site security
Currently rented @ \$620/w

Sitting on the fringe of Sydney's inner west and inner city, its popular location is 5km from the CBD, 5 minute walk to

Land Size : 56 sqm
View : <https://www.parkproperties.com.au/sale/nsw/inner-west/erskineville/residential/apartmen>
t/5692741



Melissah McCaffery J P
02 9565 5333



Rebecca Voncina
02 9565 5333

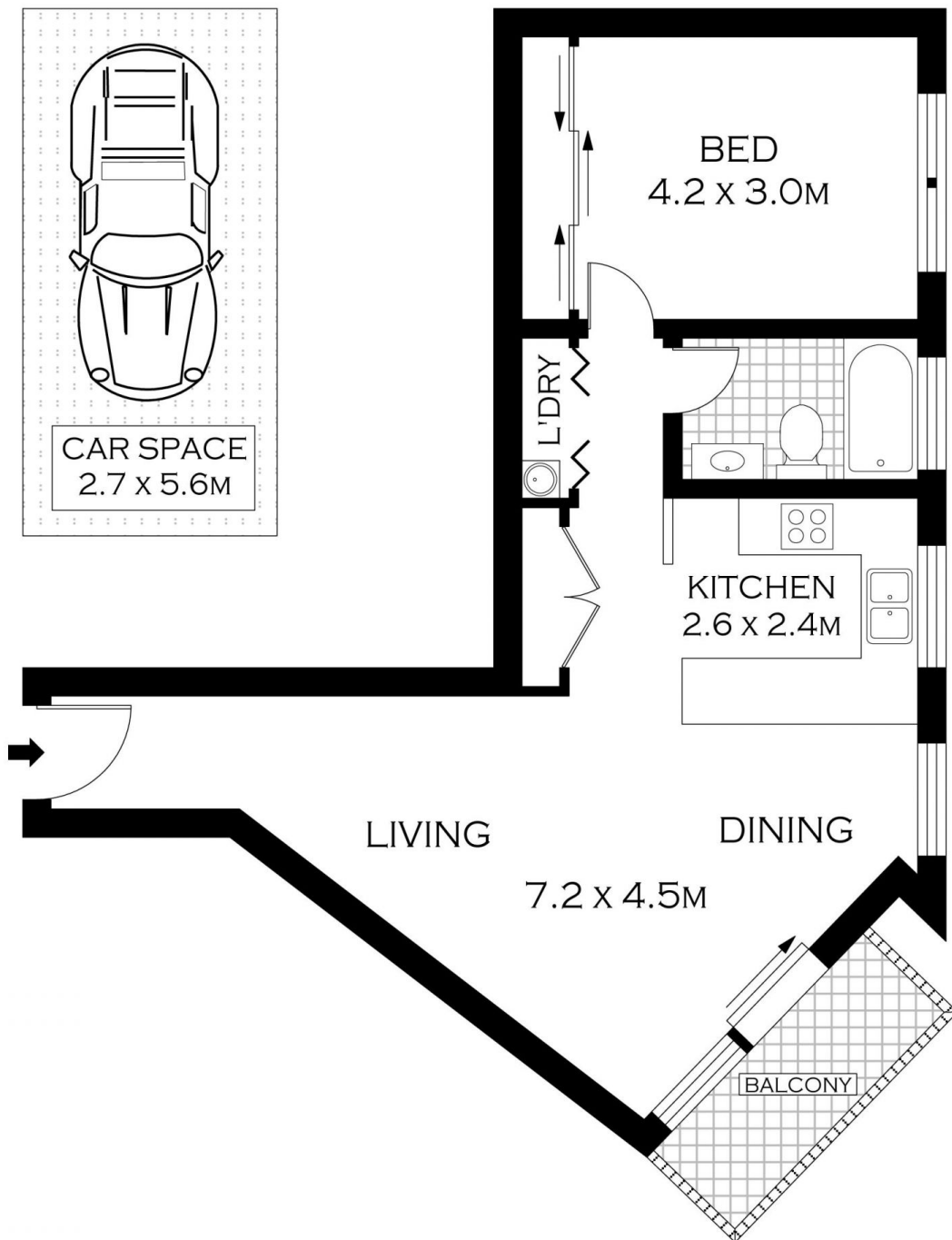

LEVEL THREE



SCALE (METRES)

PLANS SHOWN ONLY INDICATIVE OF LAYOUT. DIMENSIONS ARE APPROXIMATE.
 Floor plans by www.realestatemarketingaustralia.com.au
 Ref. No: 7280



parkproperties
 (Aust) Pty Ltd

6301 / 177-219 MITCHELL ROAD

ERSKINEVILLE