



13502/177-219 Mitchell Road Erskineville NSW

1  1  1 

This desirable park-side retreat delivers the essence of inner-city living within tranquil surrounds, offering 86 sqm on title and a generous entertainer's balcony with park views. The ideal first home or lucrative investment for the savvy opportunist.

Price : \$ 701,500

View : <https://www.parkproperties.com.au/sale/nsw/inner-west/erskineville/residential/apartment/5255274>

Open plan living & dining area w/ air conditioning
Generous entertainers' balcony w/ park views
Spacious light filled master bedroom, w/ WIR & balcony access
Well-appointed gas kitchen w/ s/s appliances & plenty of storage
Separate study area perfect for home office, nursery or cellar
Stylish bathroom w/ tub & laundry facilities
Secure car space, storage box, lift access and visitor parking



Melissah McCaffery J P
02 9565 5333



Rebecca Voncina
02 9565 5333

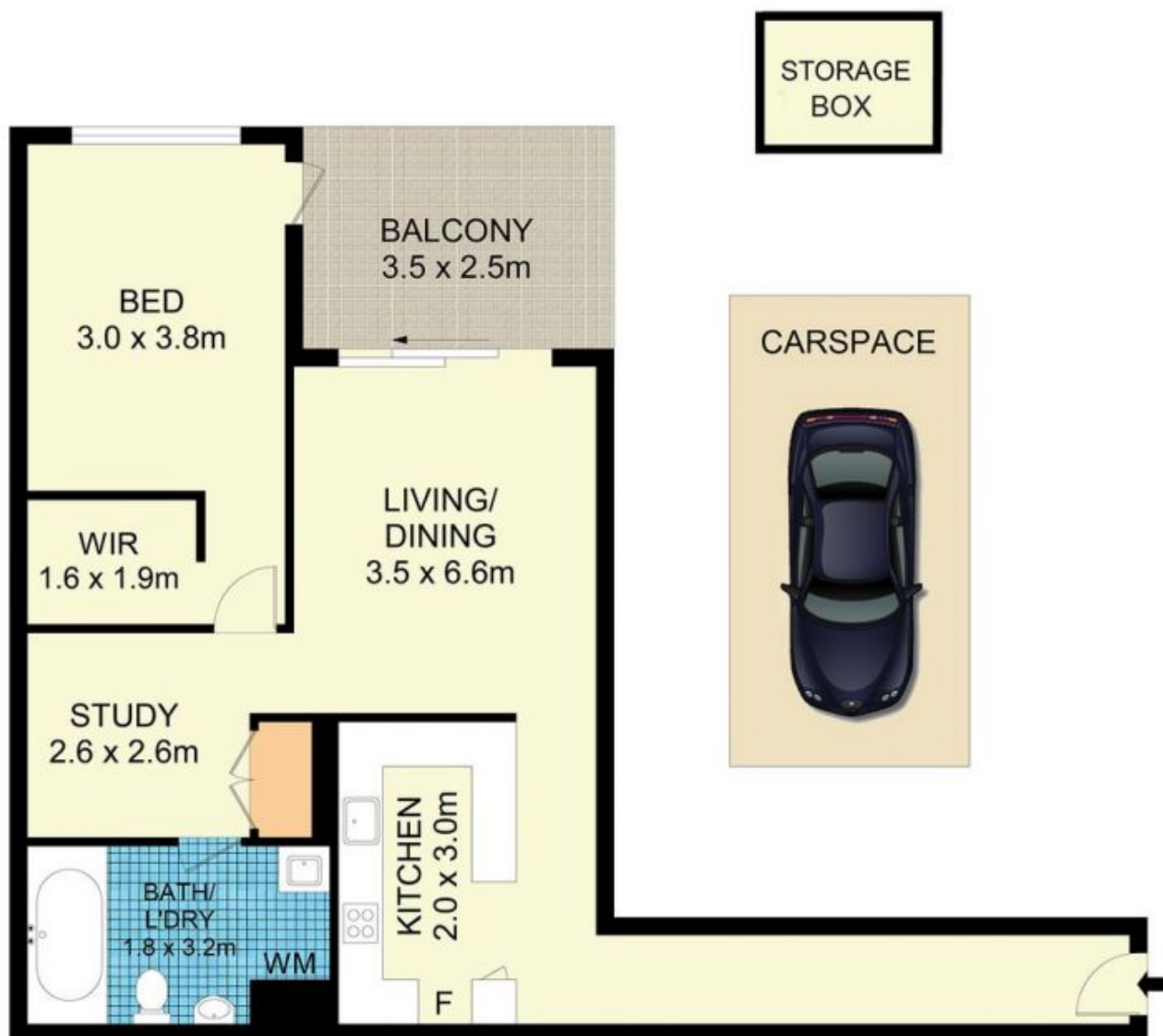

13502/177-219 Mitchell Road, Erskineville

Disclaimer

Floor Plan measurements are approximate and are for illustrative purposes only. While we cannot doubt the floor plans accuracy, we make no guarantee, warranty or representation as to the accuracy and completeness of the floor plan.