

## 2102/8 Eve Street Erskineville NSW

1  1  1 

Showcasing modern interiors & open plan layout, this apartment is positioned on the ground floor & boasts in/outdoor living. Set within one of Erskineville's most sought after developments 'Motto', it is a must to inspect.

Open plan living flowing to the courtyard w/ private entrance

Designer gas kitchen w/ caesar stone bench tops, s/s appliances & integrated dishwasher

Generous bedroom w/ air conditioning & dual BIR's

Chic bathroom w/ laundry facilities & dryer

Undercover parking w/ secure double storage box

Pet friendly security complex w/ intercom, lift access & outdoor swimming pool

Motto boasts excellent convenience and lifestyle with Sydney Park only moments down the road and an easy

**Price** : \$ 790,000

**Land Size** : 93 sqm

**View** : <https://www.parkproperties.com.au/sale/nsw/inner-west/erskineville/residential/apartmen/t/5048429>



**Michael McCaffery**  
02 9565 5333



**Rebecca Voncina**  
02 9565 5333

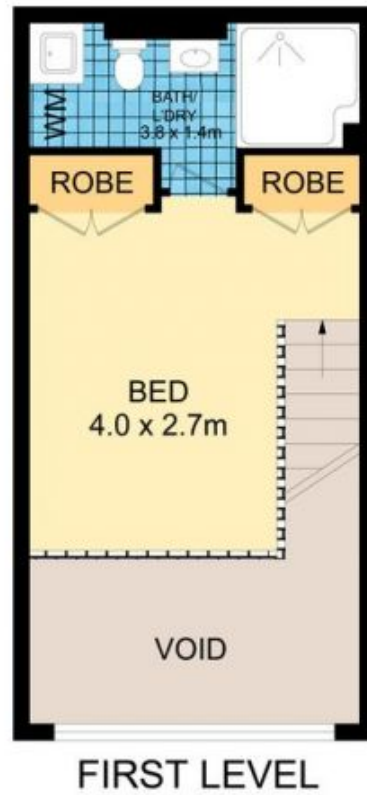

## 2102/8 Eve Street, Erskineville



### Disclaimer

Floor Plan measurements are approximate and are for illustrative purposes only. While we cannot doubt the floor plans accuracy, we make no guarantee, warranty or representation as to the accuracy and completeness of the floor plan.