



2101/8 Eve Street Erskineville NSW

1  1 

Showcasing modern interiors with an abundance of natural light, this dual level residence positioned on the ground floor with private entertainer's courtyard is one of a kind. Set within arguably one of Erskineville's most sought after developments 'Motto', it boasts stylish executive living perfect for first home buyers or astute investors alike.

Land Size : 78 sqm
View : <https://www.parkproperties.com.au/sale/nsw/inner-west/erskineville/residential/apartmen/4704294>

Light filled open plan lounge & dining area w/ floor to ceiling windows
Entertainer's courtyard w/ covered area & rear access
Designer gas kitchen w/ Caesar stone bench tops, s/s appliances & integrated dishwasher
Generous loft style bedroom w/ dual BIR's
Chic bathroom w/ laundry facilities & dryer
Pet friendly security complex w/ intercom, lift access & outdoor swimming pool



Michael McCaffery
02 9565 5333



Rebecca Voncina
02 9565 5333

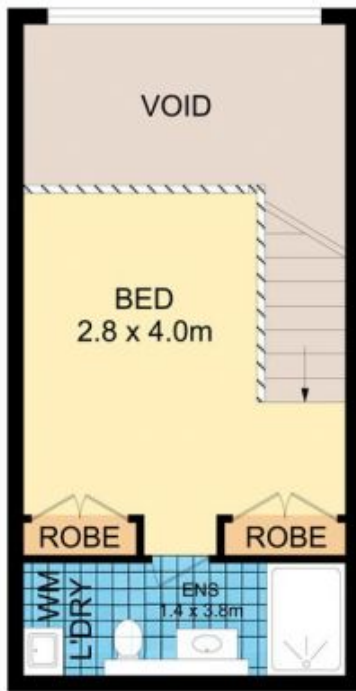

FIRST LEVEL



ENTRY LEVEL

2101/8 Eve Street, Erksineville



Disclaimer

Floor Plan measurements are approximate and are for illustrative purposes only. While we cannot doubt the floor plans accuracy, we make no guarantee, warranty or representation as to the accuracy and completeness of the floor plan.