

11505/177-219 Mitchell Road Erskineville NSW

1  1  1 

Set in the sought after & highly convenient Sydney Park Village, this fifth floor one bedroom apartment is an ideal first home, downsize or investment. Move in or rent out whilst planning for the future w/ a lucrative opportunity to own this low-maintenance lifestyle base.

Price : \$ 632,000

View : <https://www.parkproperties.com.au/sale/nsw/inner-west/erskineville/residential/apartment/4305521>

Spacious open plan lounge & dining leading out to the entertainer's balcony
Spacious master bedroom w/ built in robe
Modern gas kitchen w/ s/s appliances & storage
Stylish bathroom w/ tub & laundry facilities
Separate study area perfect for home office, nursery or cellar
Secure car space, lift access and visitor parking



Michael McCaffery
02 9565 5333



Melissah McCaffery J P
02 9565 5333

Placed just steps from the hip Erskineville Village, the eat streets of King and Crown Streets and minutes to Pinos,

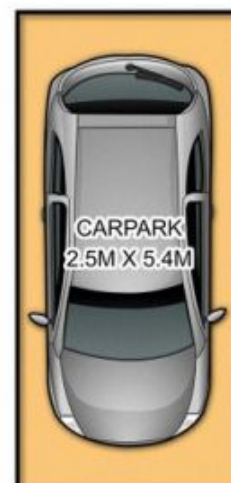
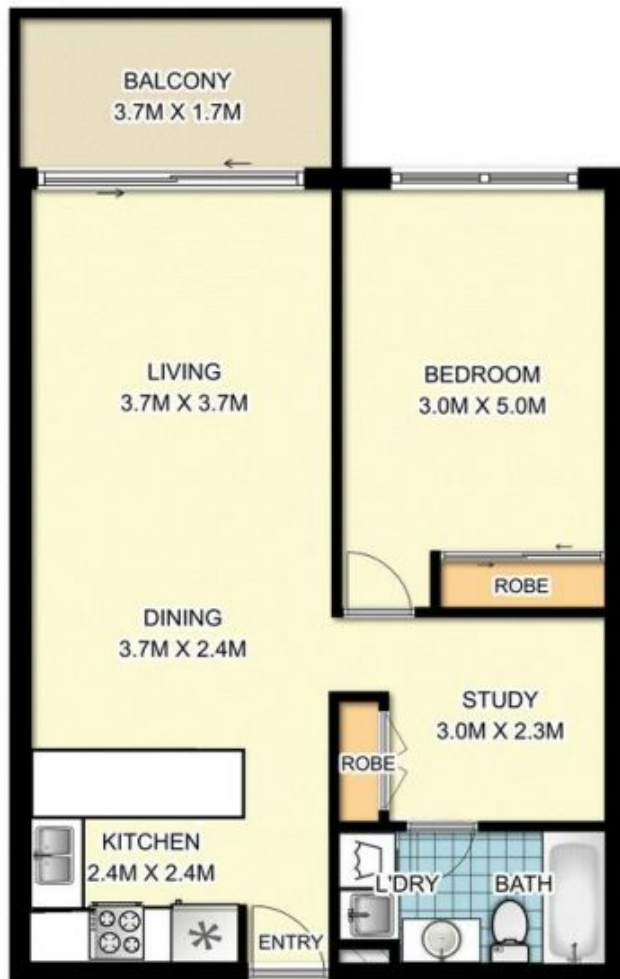

0 1 2 3m
1:75



11505 / 177-219 Mitchell Road, Erskineville

DISCLAIMER: SYDRealEstatePhoto accepts no liability for the accuracy of details contained within our floor plans. The plan scale in meters. Indicative only. Dimensions are approximate. All information contained here in is gathered from sources we believe to be reliable. However we cannot guarantee its accuracy and interested persons should rely on their own enquiries.