



10310/177-219 Mitchell Road ERSKINEVILLE NSW

1  1  1 

Located in the highly sought after lifestyle complex Sydney Park Village, this one bedroom, one bathroom apartment is generous in size and features. Naturally bright with a free flowing floorplan and ideal northerly aspect, this apartment is ideal for those seeking space & lifestyle in an urban locale.

Generous open plan lounge & dining area
Designer gas kitchen w stainless steel appliances
Sun-filled entertainers balcony w complex views
Spacious bedroom w built-ins & balcony access
Stylish bathroom w tub & separate laundry w dryer
Ceiling fans & generous storage space t/out
Secure car space & ample visitor parking

Placed just steps from the hip Erskineville Village, the eat streets of King and Crown Streets and minutes to The

Price : \$ 600

View : <https://www.parkproperties.com.au/lease/nsw/inner-west/erskineville/residential/apartment/3308180>



Beau McCaffery
02 9565 5333

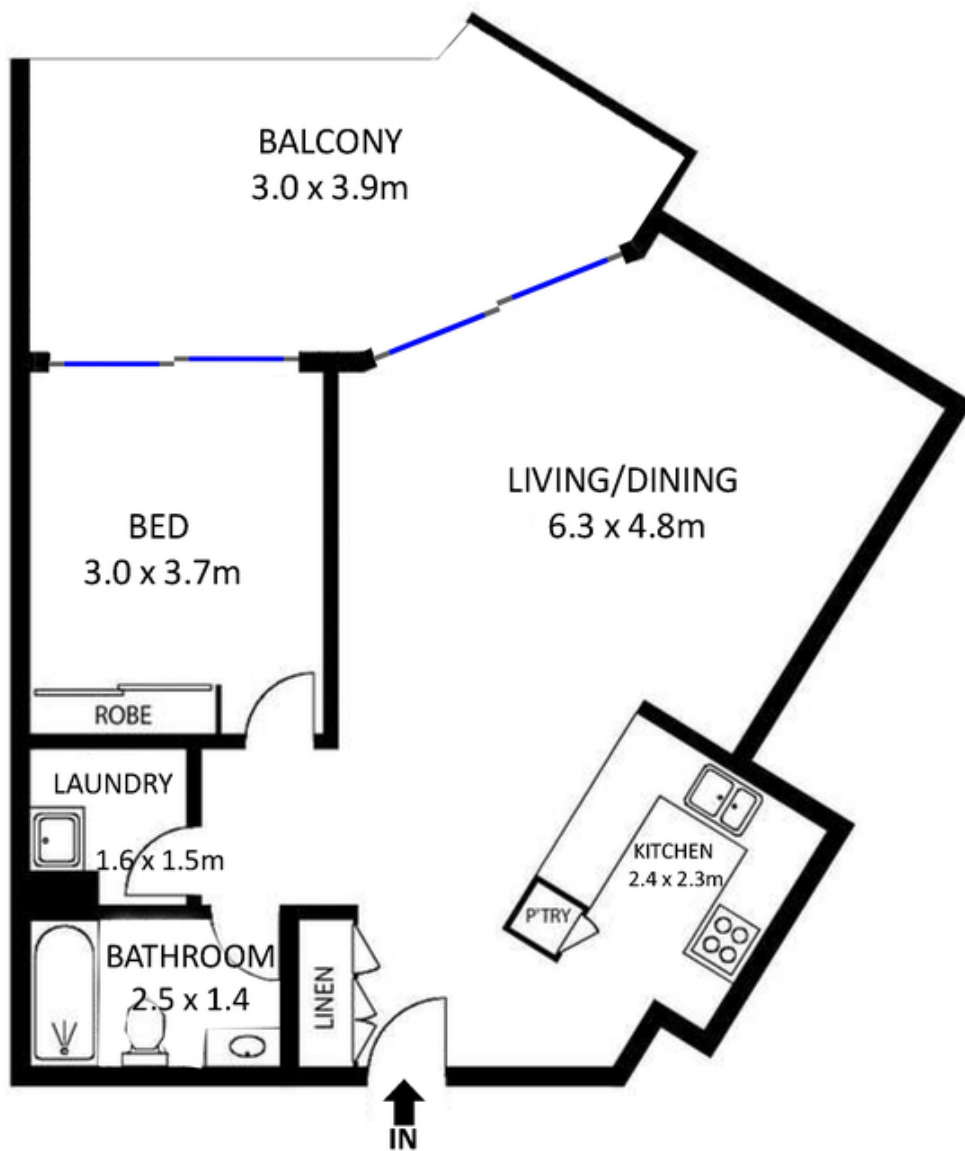

LEVEL THREE

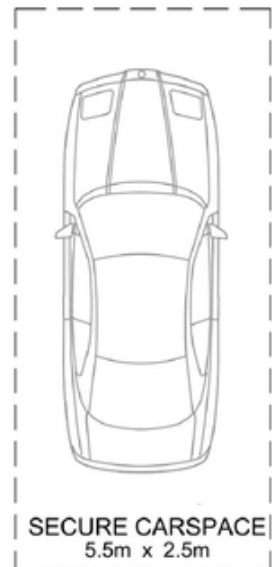

BASEMENT

10310 / 177-219 Mitchell Road, Erskineville



DISCLAIMER: THIS PLAN IS FOR ILLUSTRATIVE PURPOSES ONLY. DIMENSIONS ARE APPROXIMATE AND IT DOES NOT CONSTITUTE PART OF ANY LEGAL DOCUMENTS. POSES ONLY. DIMENSIONS ARE APPROXIMATE AND IT DOES NOT CONSTITUTE PART OF ANY LEGAL DOCUMENTS.