

10310/177-219 Mitchell Road Erskineville NSW

1  1  1 

Desirably positioned in the revered 'Sydney Park Village' and offering exceptionally peaceful and private in/outdoor living, this generously proportioned one bedroom lifestyle apartment is the perfect hybrid of resort-style ambience and optimum convenience.

Expansive open plan living/ dining that allows for relaxation & entertaining
North facing terrace offering optimum privacy & leafy internal outlook
Well-appointed gas kitchen w/ s/s appliances & plentiful storage
Large sun drenched bedroom w/ floor-to-ceiling BIR & direct balcony access
Contemporary bathroom w/ tub & separate laundry room w/ dryer
Secure undercover parking, ample visitor parking & 24 hour

Price : \$ 683,000

View : <https://www.parkproperties.com.au/sale/nsw/inner-west/erskineville/residential/apartment/3193270>



Melissah McCaffery J P
02 9565 5333

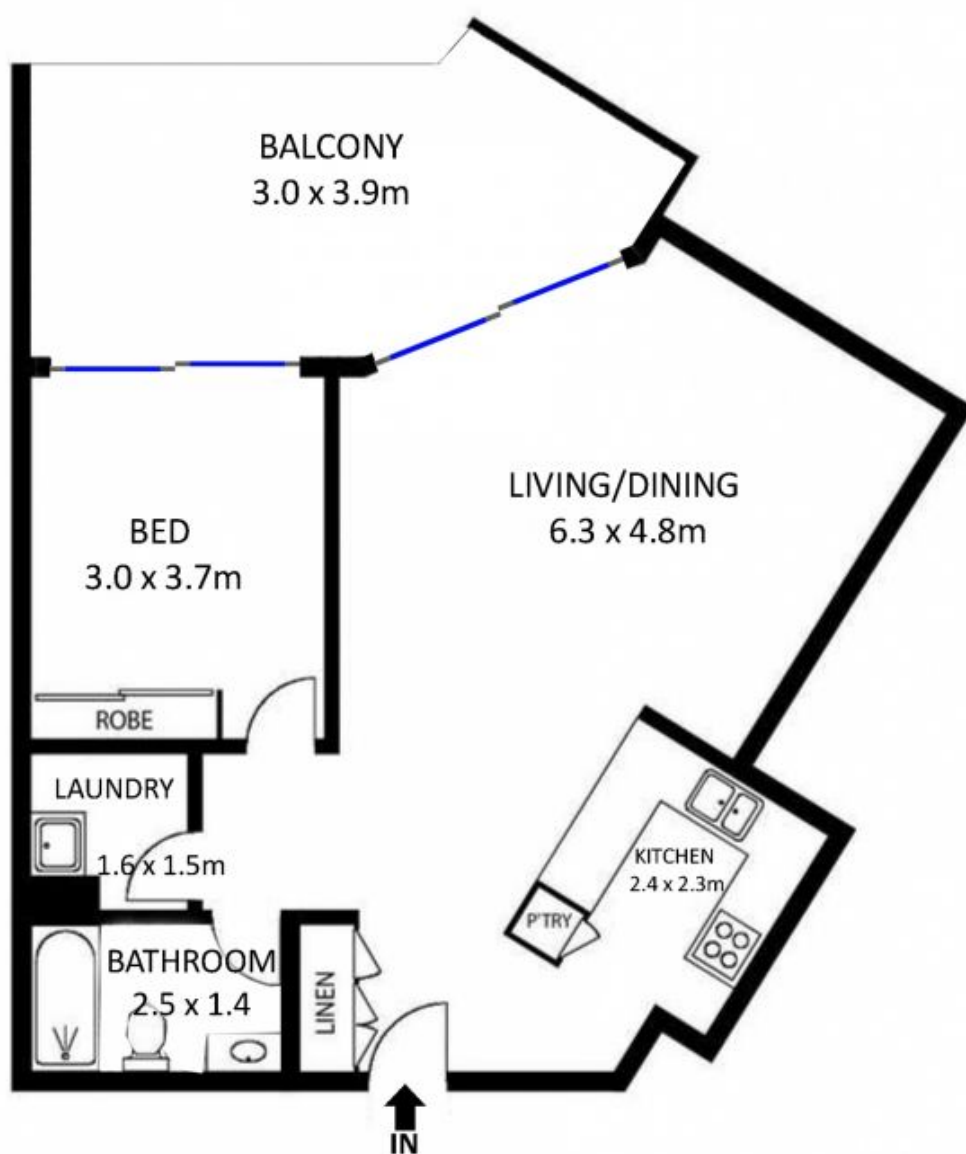

LEVEL THREE

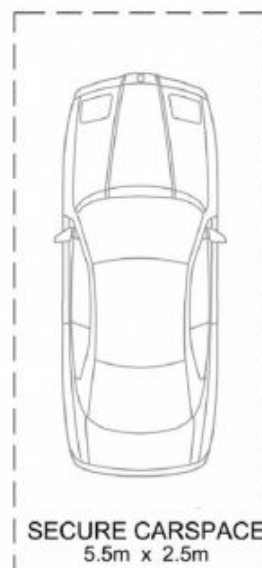

BASEMENT

10310 / 177-219 Mitchell Road, Erskineville



DISCLAIMER: THIS PLAN IS FOR ILLUSTRATIVE PURPOSES ONLY. DIMENSIONS ARE APPROXIMATE AND IT DOES NOT CONSTITUTE PART OF ANY LEGAL DOCUMENTS. POSES ONLY. DIMENSIONS ARE APPROXIMATE AND IT DOES NOT CONSTITUTE PART OF ANY LEGAL DOCUMENTS.