

15103/177-219 Mitchell Road Erskineville NSW

1  1  1 

Boasting a generously sized courtyard, this modern one bedroom apartment is perfect for entertaining. Set within the Inner West's highly sought after Sydney Park Village this apartment is not to be missed!

Price : \$ 700,000

View : <https://www.parkproperties.com.au/sale/nsw/inner-west/erskineville/residential/apartment/2392907>

Modern gas kitchen with stainless steel appliances
Stylish bathroom with tub and laundry facilities
Good sized bedroom with courtyard access
Versatile study perfect for home office or nursery
Open plan living and dining
Entertainer's courtyard
Secure carspace on title
Intercom access



Melissah McCaffery J P
02 9565 5333

Placed just steps from the hip Erskineville Village, the eat streets of King and Crown Streets and minutes to The Grounds, Campos, Rosetta Stone Bakery, Bread & Circus,

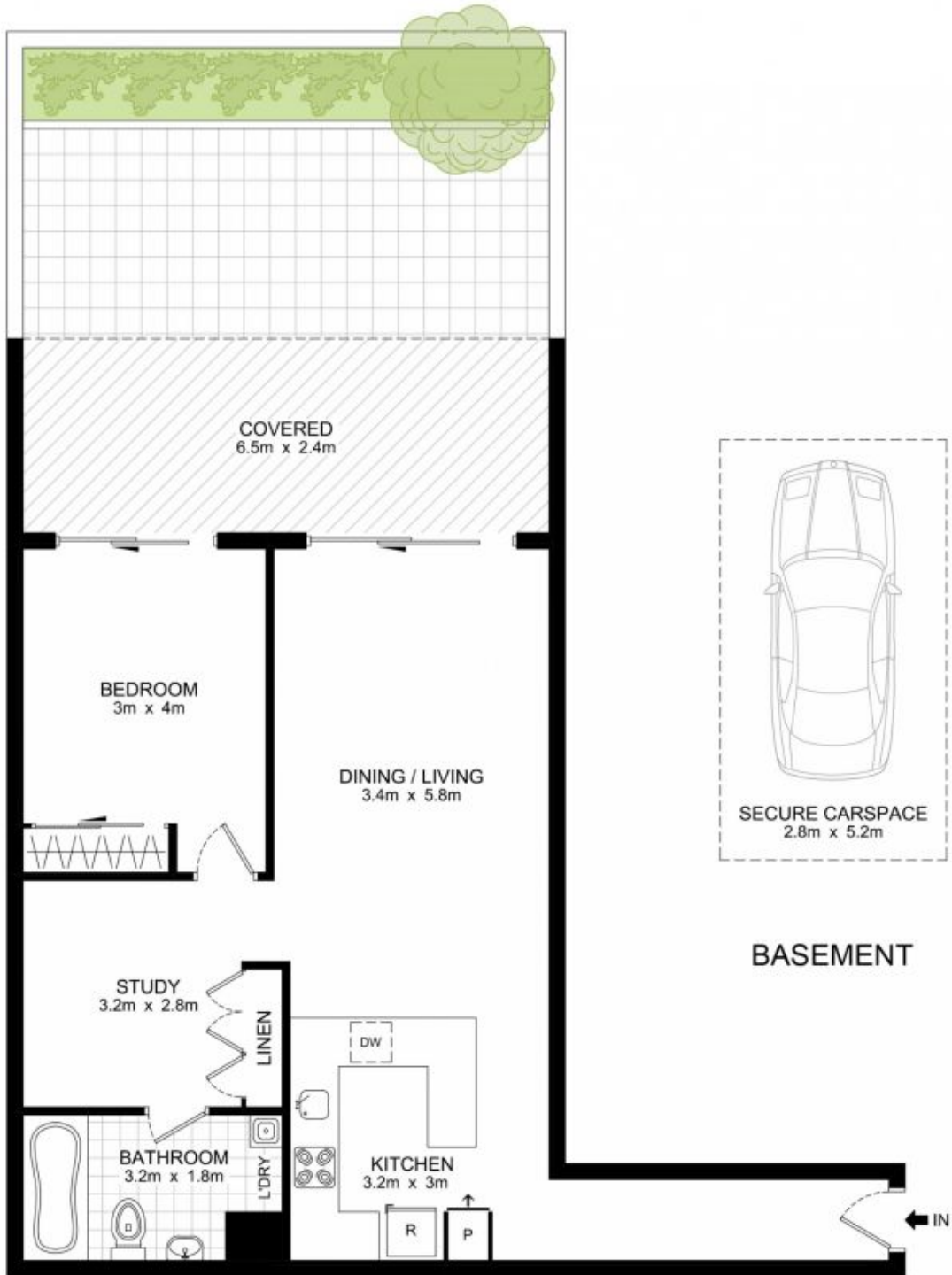

GROUND FLOOR

15103/177-219 Mitchell Road, Erskineville

DISCLAIMER: THIS PLAN IS FOR ILLUSTRATIVE PURPOSES ONLY. DIMENSIONS ARE APPROXIMATE AND IT DOES NOT CONSTITUTE PART OF ANY LEGAL DOCUMENTS.

