



8501/177-219 Mitchell Road Erskineville NSW

1  1  1 

Flooded with natural light this 5th floor apartment takes full advantage of the city views from both balconies off the living & bedroom. This apartment is ready to be occupied having been graced by fresh paint & new carpet throughout. Opportunities like this are fleeting & will attract owner occupiers & investors who enjoy the resort style facilities & the convenience to Erskineville that Sydney Park Village offers.

- * Large master bedroom with built in robe & sunny balcony
- * Light filled living with balcony in a neutral colour palette
- * Open plan gas kitchen with dishwasher
- * Separate internal laundry
- * Highly prized secure undercover parking

Placed just steps from the hip Erskineville Village, the urban oasis of Sydney Park, and the eat streets of King

Price : \$ 550,000

View : <https://www.parkproperties.com.au/sale/nsw/inner-west/erskineville/residential/apartment/1697627>



Melissah McCaffery J P
02 9565 5333

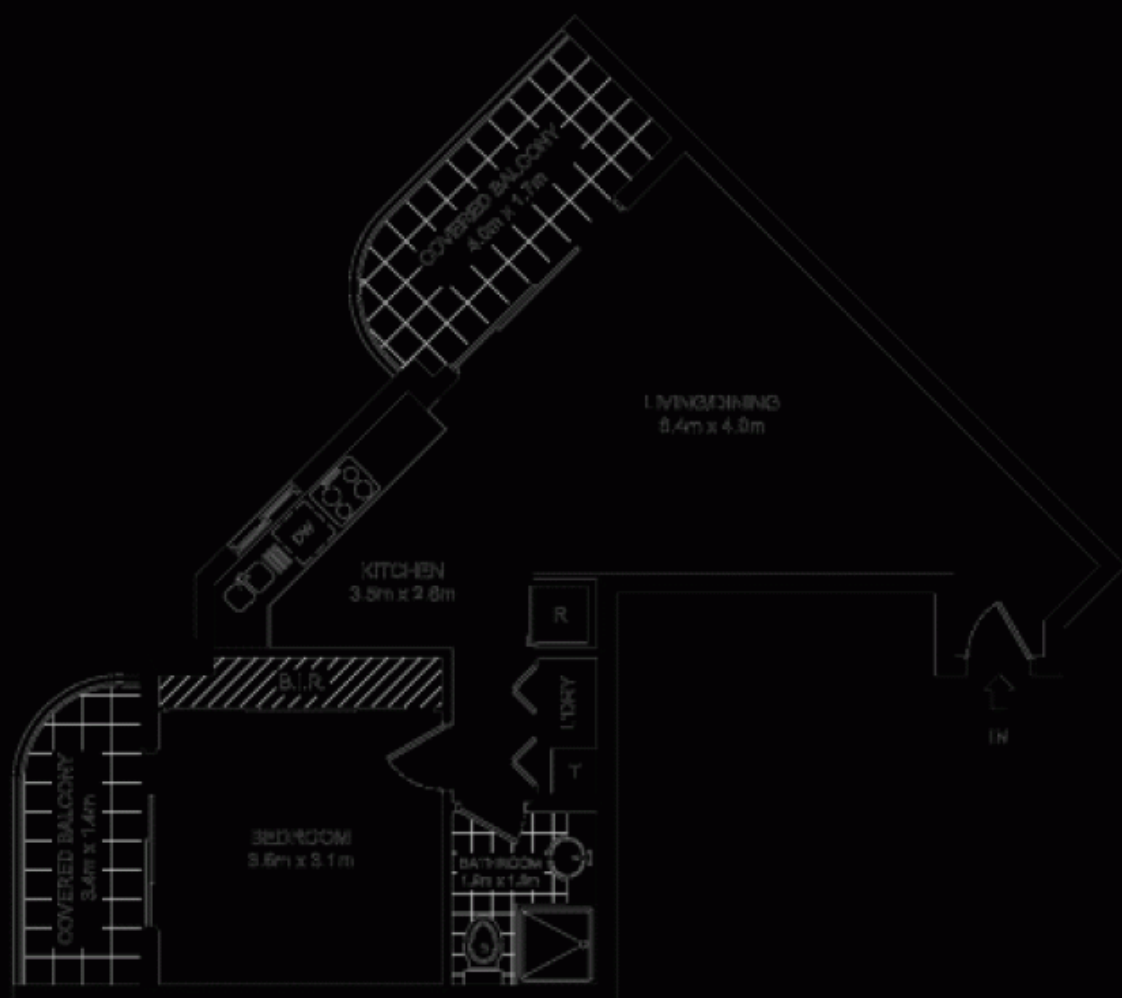

LEVEL 1.5

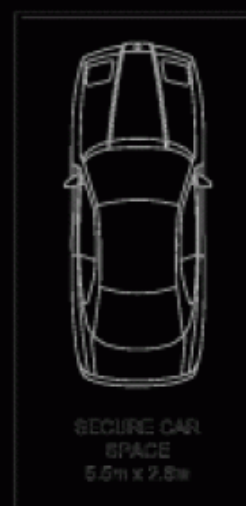

LEVEL 1.0

004004179177 24130 191 Gas "C" Roadway Creek "new" 0



THIS PLAN IS TO BE USED BY THE LAND OWNER FOR THE PURPOSES OF THE LOCAL GOVERNMENT ACT 2009 AND THE LOCAL GOVERNMENT ACT 2009. THE LAND OWNER IS NOT RESPONSIBLE FOR THE ACCURACY OF THE INFORMATION PROVIDED ON THIS PLAN. THE LAND OWNER IS NOT RESPONSIBLE FOR THE ACCURACY OF THE INFORMATION PROVIDED ON THIS PLAN.

