





**17204/177-219 Mitchell Road Erskineville NSW**

3  2  2 

Offering urban living in the heart of Erskineville, this north facing, three bedroom plus study apartment within the highly regarded Sydney Park Village is a rare opportunity that should not be missed!

**Price** : \$ 850,000

**View** : <https://www.parkproperties.com.au/sale/nsw/inner-west/erskineville/residential/apartment/1656136>

Modern granite kitchen with stainless steel gas appliances including dishwasher  
Open plan living with defined lounge & dining spaces, north facing balcony with leafy outlook  
3 double bedrooms all with built in robes & master with ensuite & balcony access  
Separate internal laundry with dryer & linen cupboard  
Mosaic ensuite & main bathroom with bathtub  
Security building with intercom access & side by side double security car space



**Melissah McCaffery J P**  
**02 9565 5333**

Placed just steps from the hip Erskineville Village, the

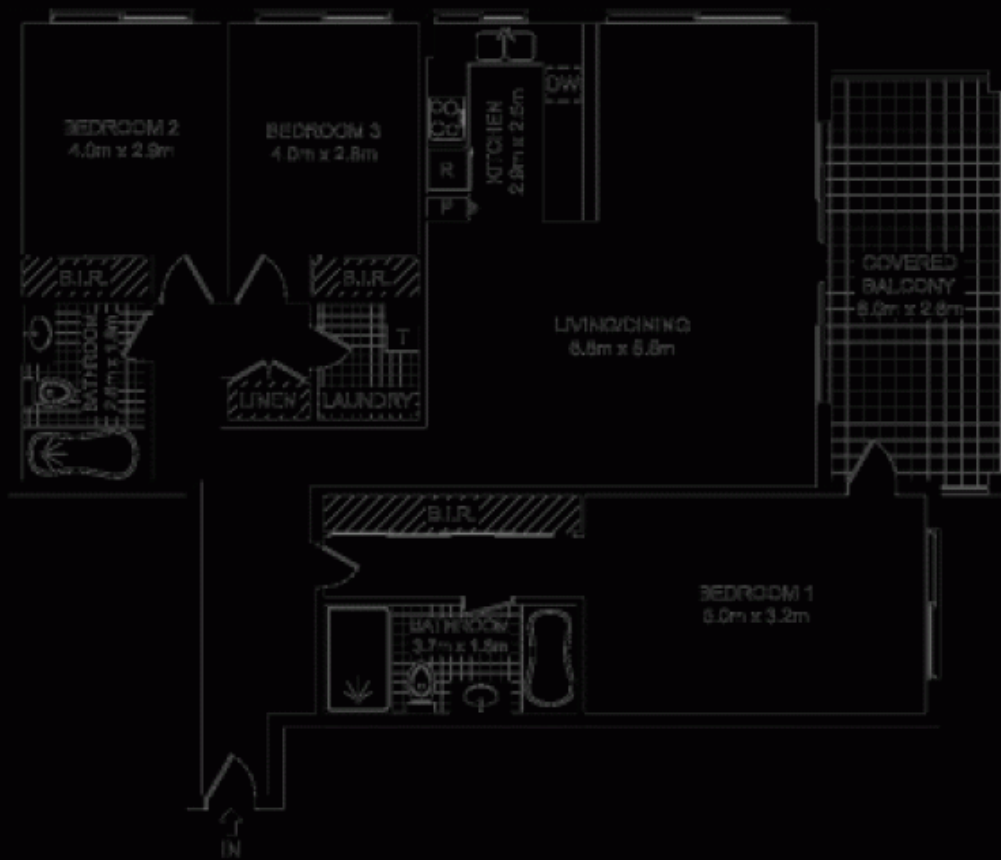

11 M 1 2



PLANS 1001 W 1

91750094177 210 Dalmore Road, Frankston VIC

THIS PLAN IS TO BE USED FOR INFORMATION PURPOSES ONLY. THE ARCHITECT DOES NOT ACCEPT LIABILITY FOR ANY COSTS INCURRED BY YOU OR YOUR CONTRACTOR.

