

9312/177-219 Mitchell Road ERSKINEVILLE NSW

1  1  1 

This internal facing one bedroom apartment features a spacious open plan living area and private entertainers balcony overlooking the manicured gardens. Only a short stroll to Erskineville Village bars and eateries and the lifestyle that King Street, Newtown has to offer.

Price : \$ 460,000

View : <https://www.parkproperties.com.au/sale/nsw/inner-west/erskineville/residential/apartment/1548967>

Accommodation

Oversized bedroom with built-in

Spacious modern kitchen with gas stainless steel appliances

Bright open plan living/dining area that flows onto your private balcony

Modern bathroom with bath

Internal laundry with dryer



Melissah McCaffery J P
02 9565 5333

Lifestyle

Indoor 25m lap pool

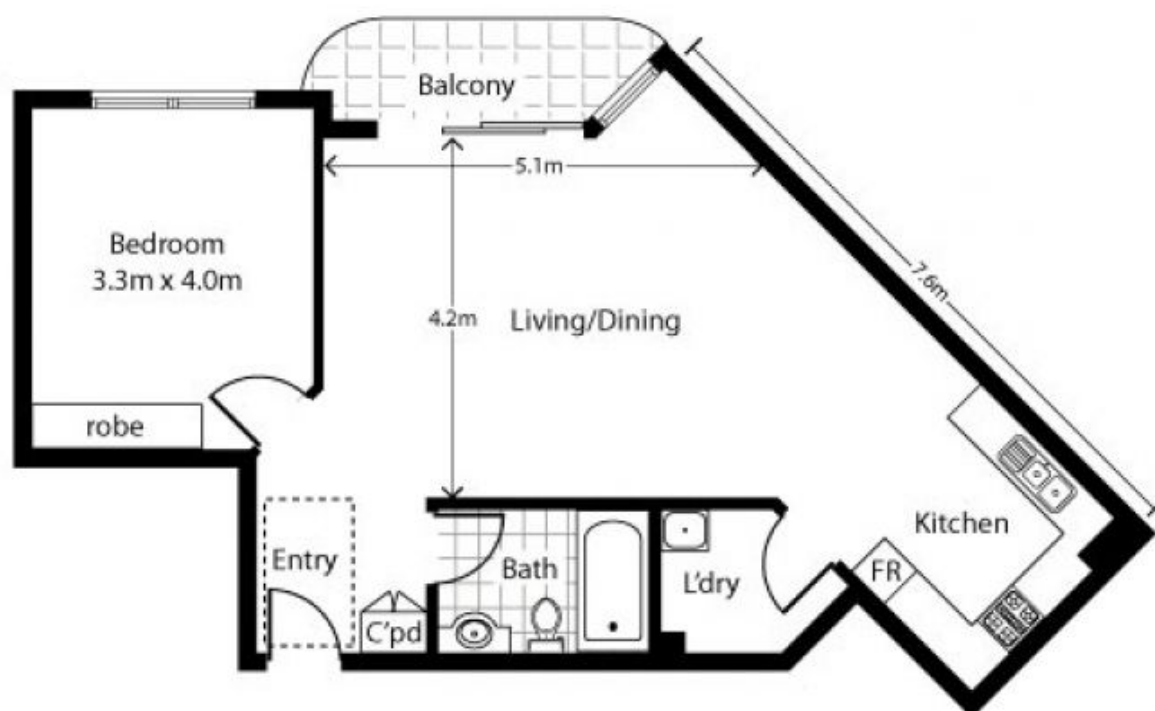

Carspace

9312/177 Mitchell Road, Alexandria

Floorplan by Only Real Estate Ph: 1300 760 390

DISCLAIMER: PLANS SHOWN ARE FOR PRESENTATION PURPOSES AND ARE NOT PART OF ANY LEGAL DOCUMENT. ALL MEASUREMENTS AND FIGURES ARE APPROXIMATE.