



17605/177-219 Mitchell Road Erskineville NSW

2  2  1 

Peacefully set away from the complex with views to the city, this 100sqm apartment offers low maintenance living in an urban sanctuary.

Versatile floor plan

Master bedroom with walk in wardrobe and ensuite

Second bedroom with built in wardrobe

Open plan, modern kitchen with pull out pantry and dishwasher

Main mosaic tiled bathroom with bath

Internal laundry

Air conditioning

Placed just steps from the hip Erskineville Village, the urban oasis of Sydney Park, and the eat streets of King and Crown Streets Sydney Park Village is one of the most sought after resort style buildings in inner Sydney. With

Land Size : 100 sqm

View : <https://www.parkproperties.com.au/sale/nsw/inner-west/erskineville/residential/apartmen>
t/1536289



Melissah McCaffery J P
02 9565 5333

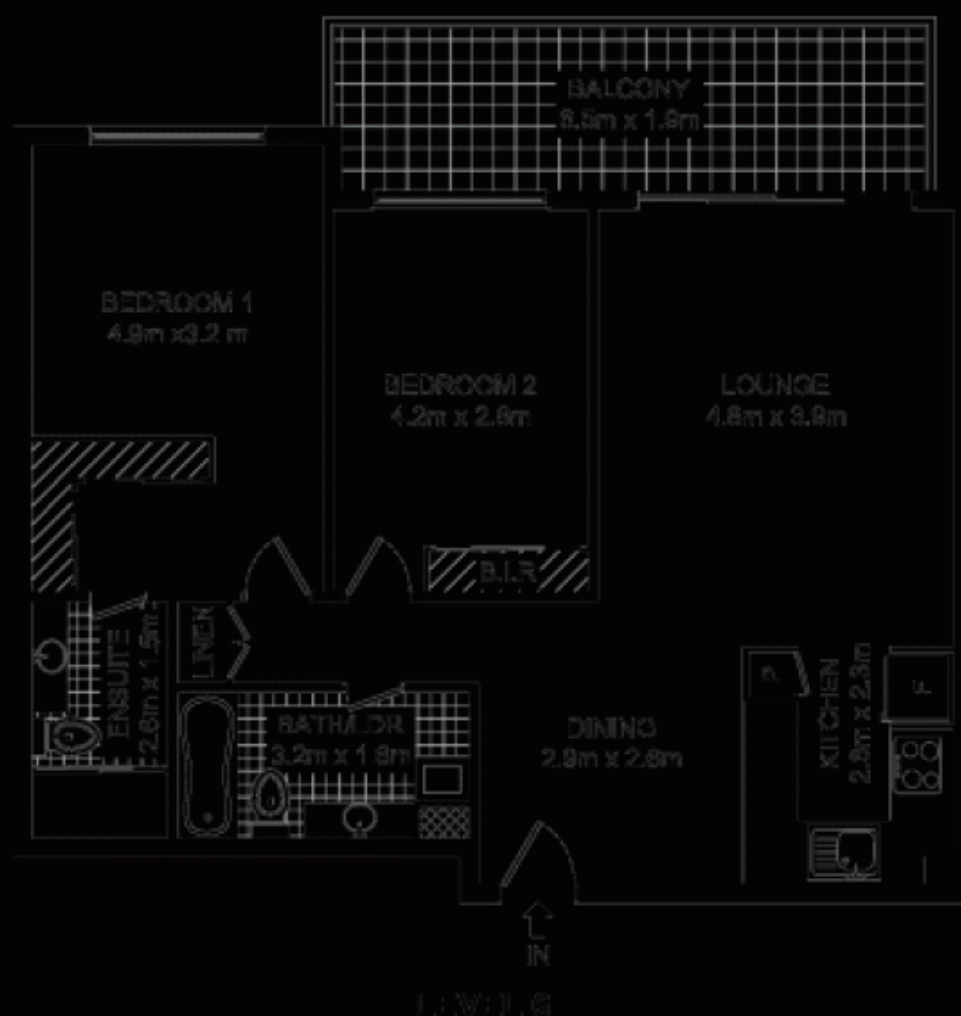

3.5m x 1.8m

4.2m x 2.8m

4.8m x 3.2m



RENDERING IS NOT TO SCALE. DIMENSIONS ARE APPROXIMATE.
ALL DIMENSIONS ARE TO FACE UNLESS OTHERWISE SPECIFIED.
DIMENSIONS ARE TO FACE UNLESS OTHERWISE SPECIFIED.
DIMENSIONS ARE TO FACE UNLESS OTHERWISE SPECIFIED.

0 1m 2m 3m