



15301/177-219 Mitchell Road ERSKINEVILLE NSW

1  1  1 

Immerse yourself in the village atmosphere with the internal facing one bedroom plus study apartment with views across the gardens of Sydney Park Village.

- * Oversized bedroom with built in robe & balcony access
- * Separate study , suitable as office/nursery
- * Open plan living leading out to tranquil balcony
- * Modern Mosaic bathroom with tub & internal laundry
- * Highly prized undercover parking

Placed just steps from the hip Erskineville Village, the urban oasis of Sydney Park, and the eat streets of King and Crown Streets Sydney Park Village is one of the most sought after resort style buildings in inner Sydney. With incomparable facilities including outdoor pool, two tennis courts, gym and heated indoor pool immerse yourself in a sanctuary away from any urban buzz.

View : <https://www.parkproperties.com.au/sale/nsw/inner-west/erskineville/residential/apartment/1501498>



Melissah McCaffery J P
02 9565 5333

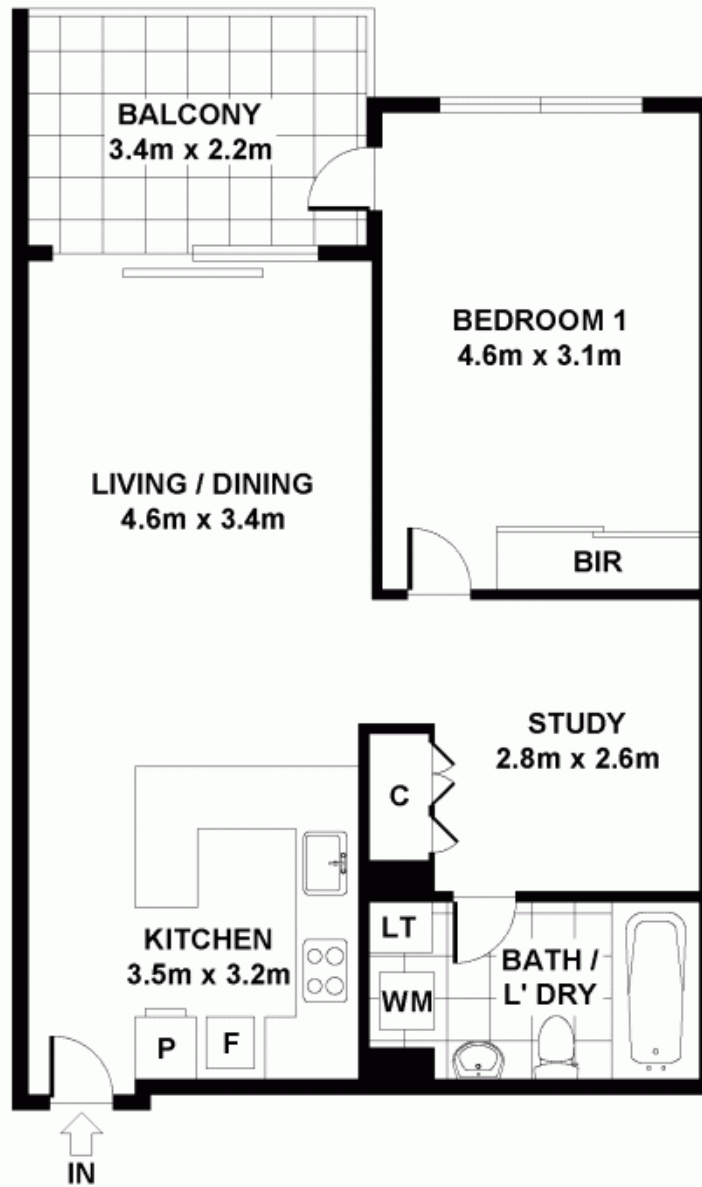

LEVEL 3

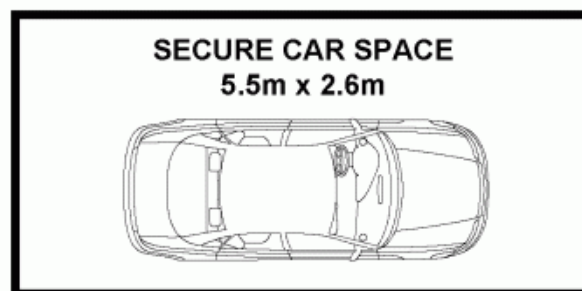

BASEMENT

ADDRESS

UNIT 15301/177 - 219 MITCHELL ROAD ERSKINEVEILLE

DISCLAIMER: THIS PLAN IS FOR
ILLUSTRATIVE PURPOSES ONLY.
DIMENSIONS ARE APPROXIMATE
AND IT DOES NOT CONSTITUTE
PART OF ANY LEGAL DOCUMENTS.

