



10407 177-219 Mitchell Road ERSKINEVILLE NSW

1  1  1 

Recently updated, this generously sized 1 bedroom plus study apartment is the perfect buy for a first home owner or the keen investor. Overlooking the luscious Sydney Park, this apartment is worth its weight in gold. The apartment layout is open plan with versatile styling throughout. The bedroom features a full length built in wardrobe and the study is separate with ample storage and space for a desk and drawers.

Large bedroom with Built in Wardrobe
Modern Kitchen with Gas cooking, stainless steel appliances and a dishwasher
Modern bathroom with bath
Balcony with views over Sydney Park
Security intercom & 24 hour on site security office
Secure car park on title with visitor parking
Very good condition, has recently been refreshed

Price : \$ 525,000

View : <https://www.parkproperties.com.au/sale/nsw/inner-west/erskineville/residential/apartment/1183195>



Melissah McCaffery J P
02 9565 5333

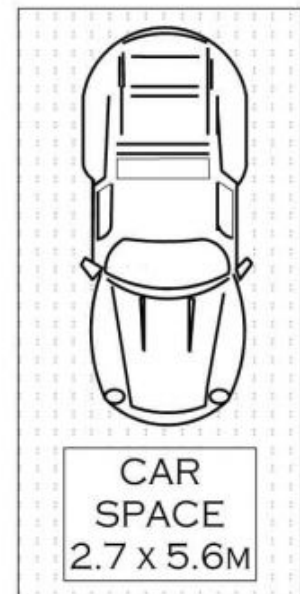
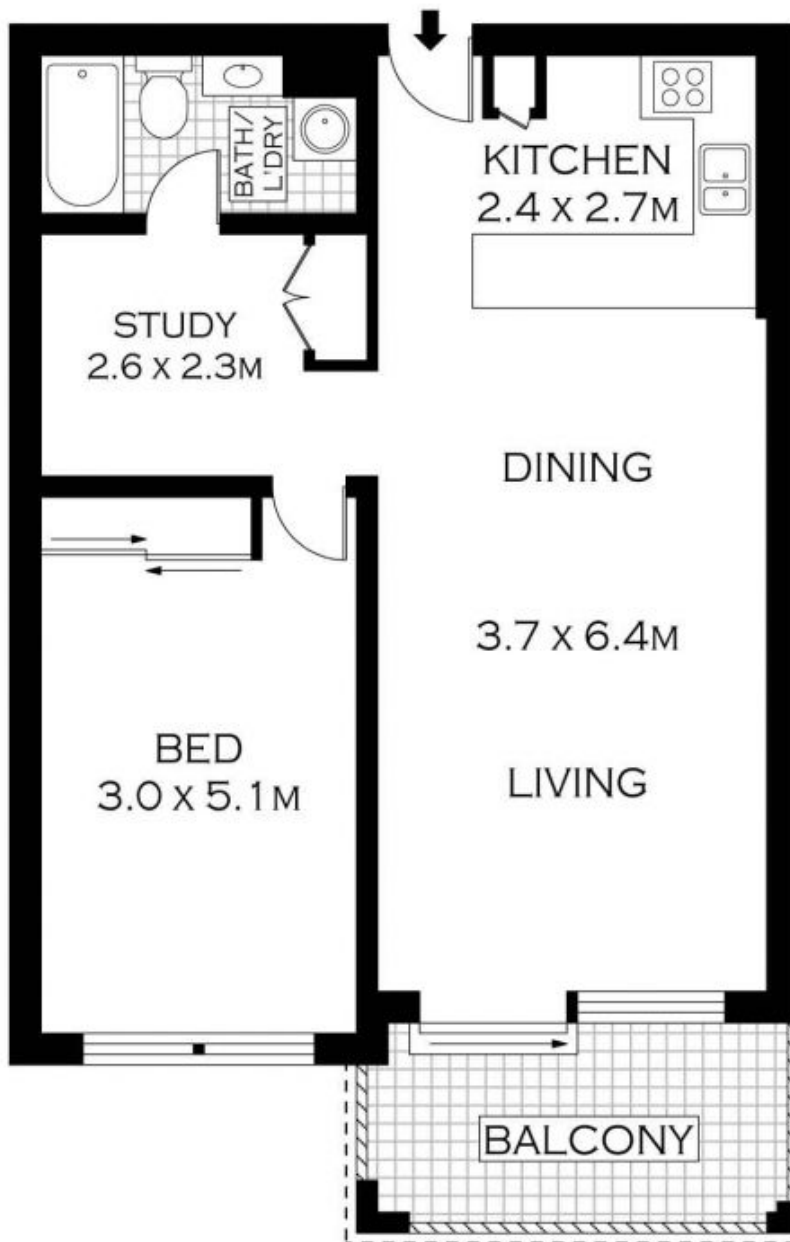

FOURTH LEVEL

NOTE :- SECURE CAR SPACE



PLANS SHOWN ONLY INDICATIVE OF LAYOUT. DIMENSIONS ARE APPROXIMATE.
Floor plans by www.realestatemarketingaustralia.com.au
Ref. No: 7229



parkproperties
(Aust) Pty Ltd

10407 / 177 - 219 MITCHELL ROAD

ERSKINEVILLE